

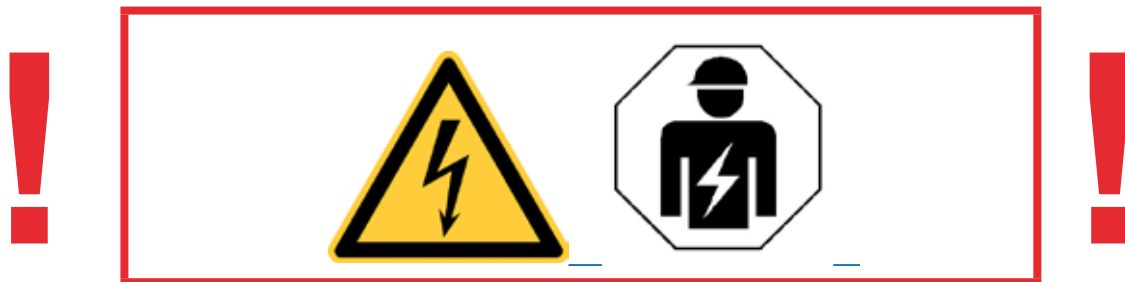





Montageanleitung
ERSATZVENTILATOR
CGL
Änderungen vorbehalten!

Installation instructions
REPLACEMENT FAN
CGL
Subject to modifications



<p>①</p>  <p>1x</p>	<p>②</p>  <p>1x</p>
<p>③</p>  <p>1x</p>	<p>④</p>  <p>1x</p>
<p>⑤</p>  <p>1x</p>	<p>⑥</p>  <p>1x</p>

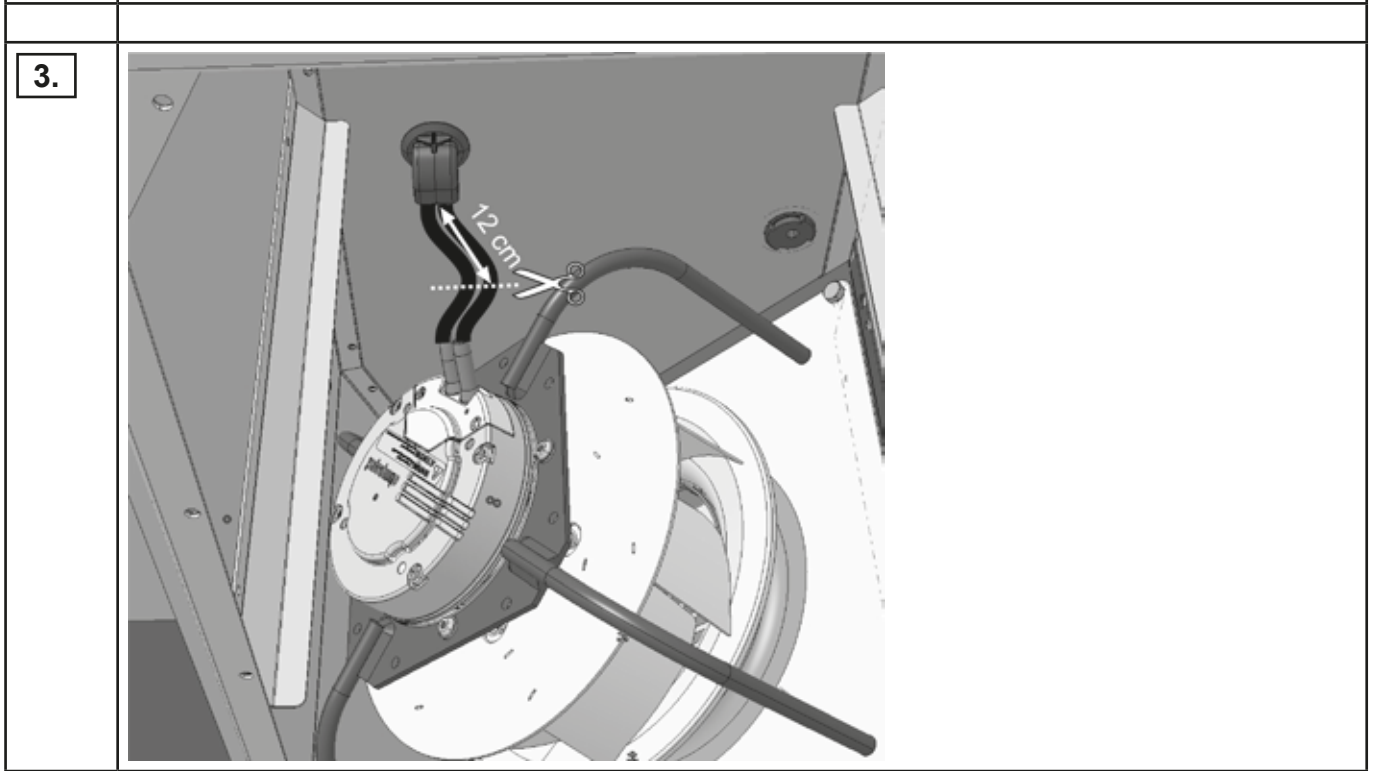
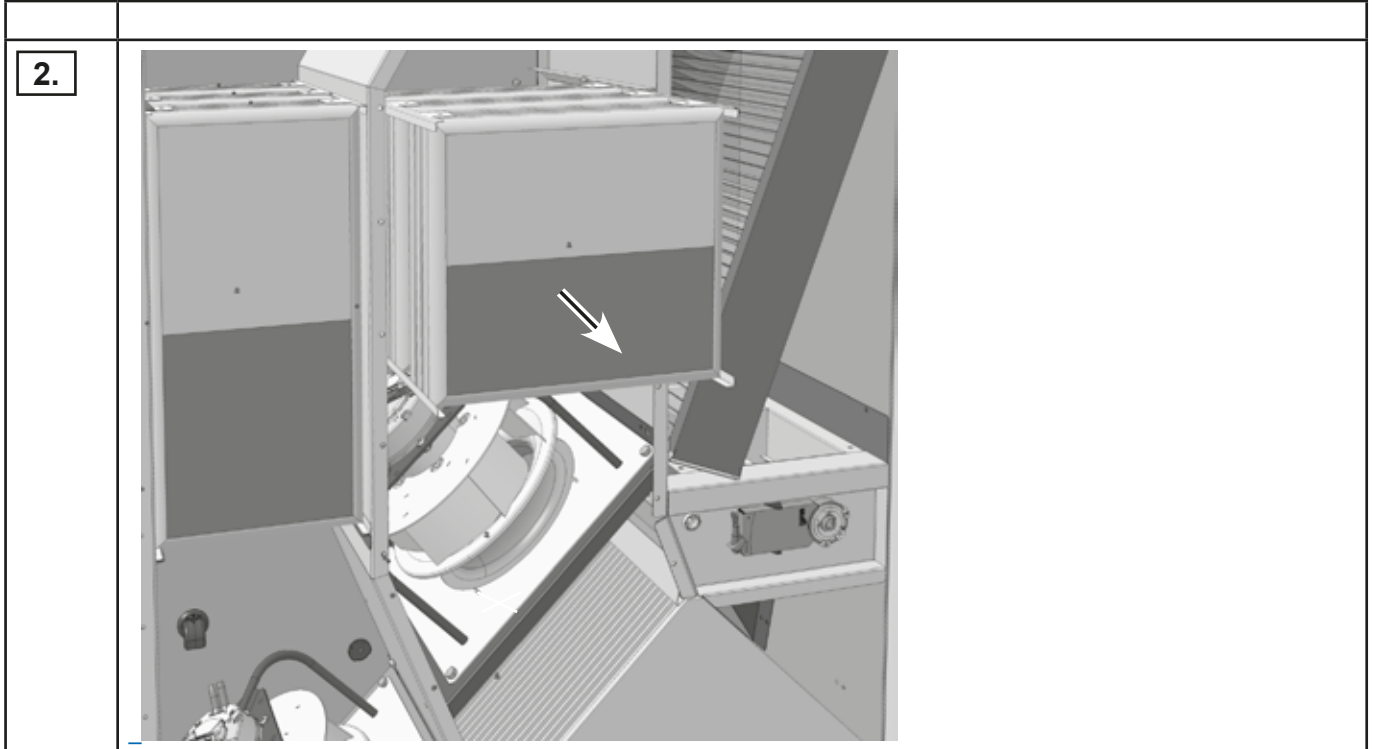
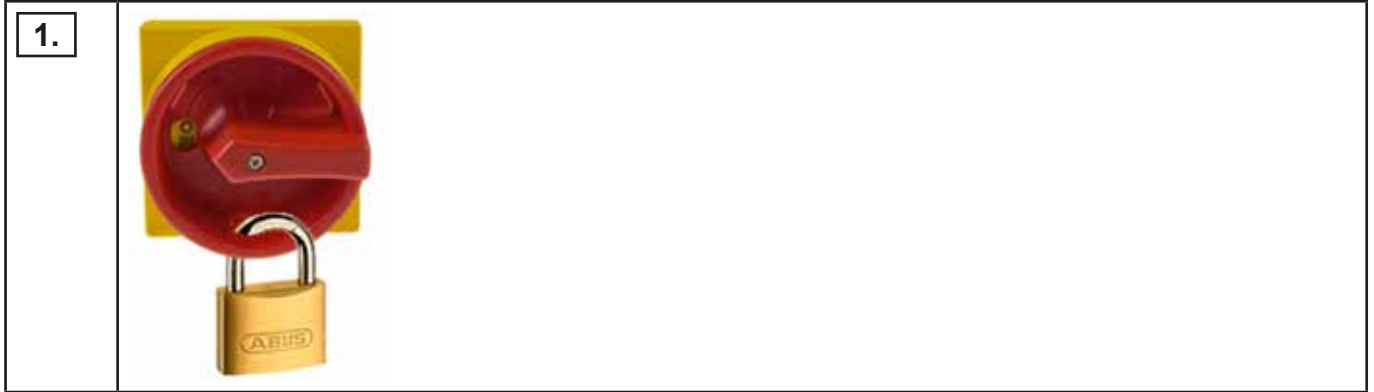

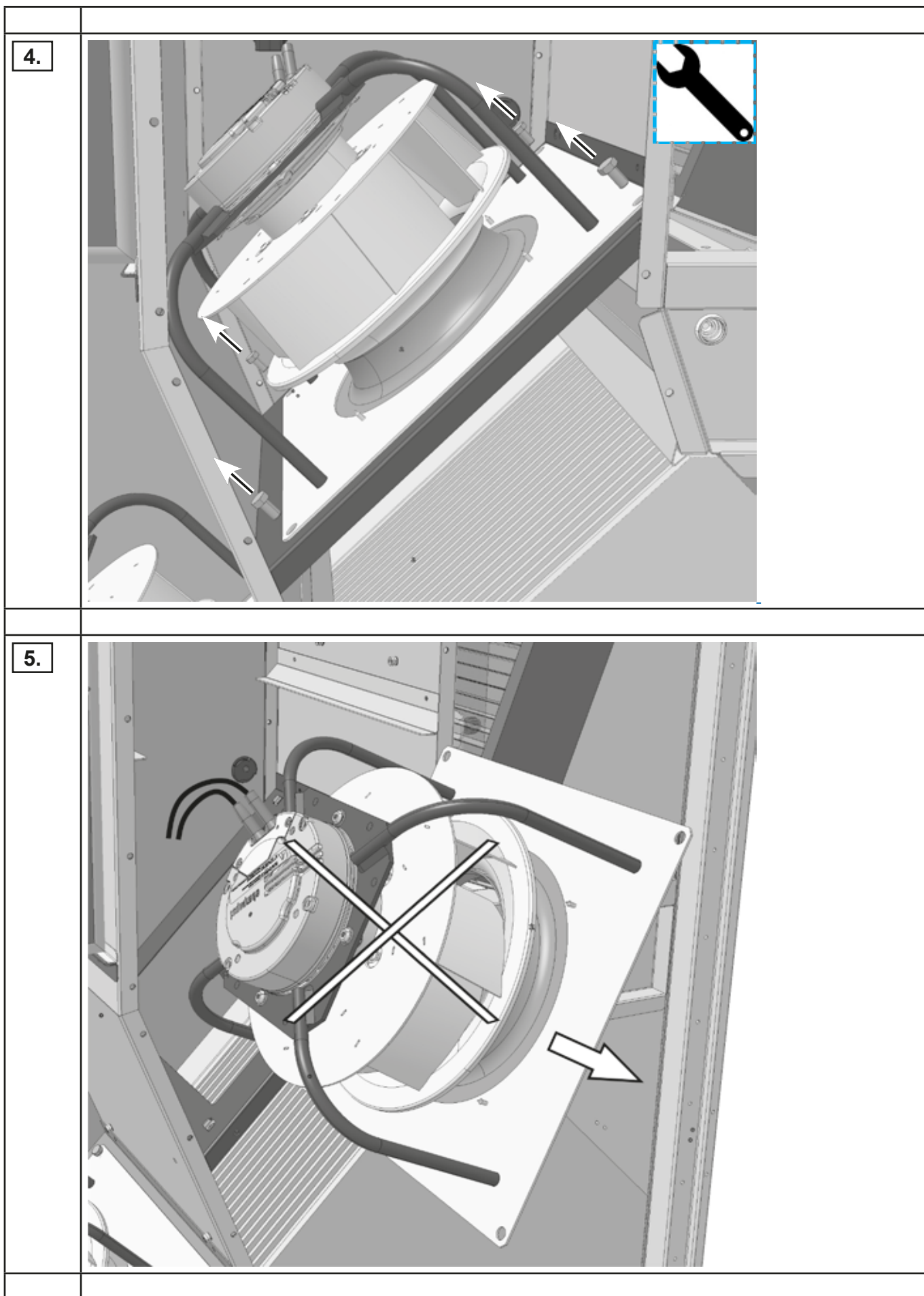

6.

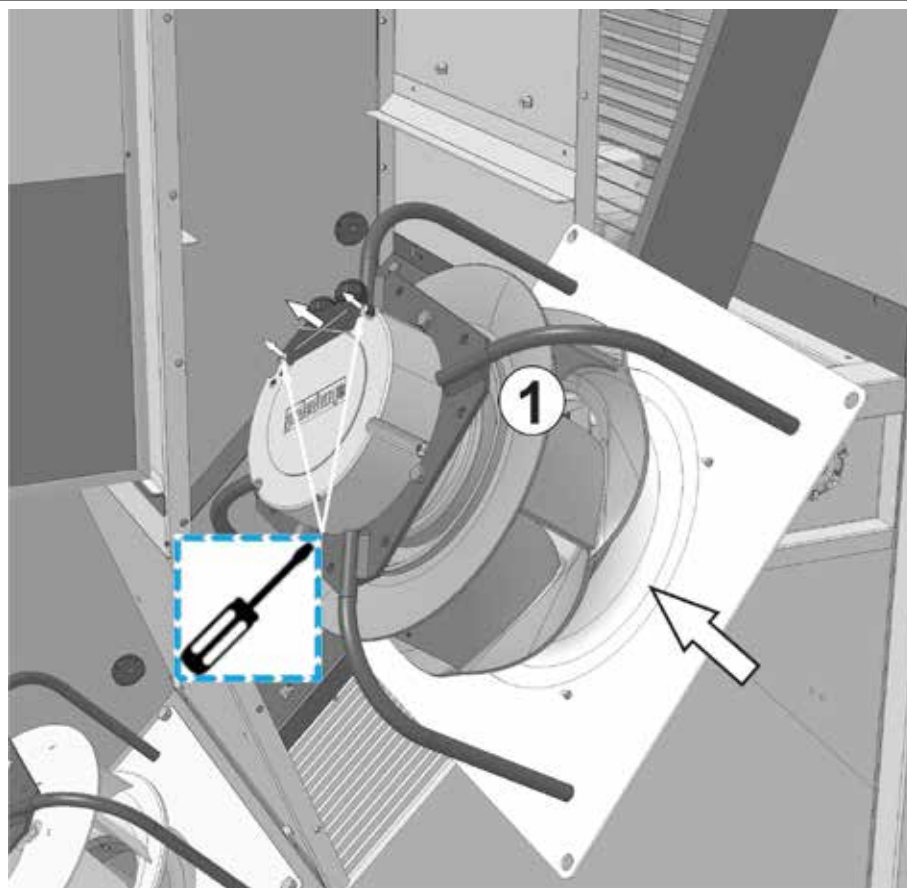

7.

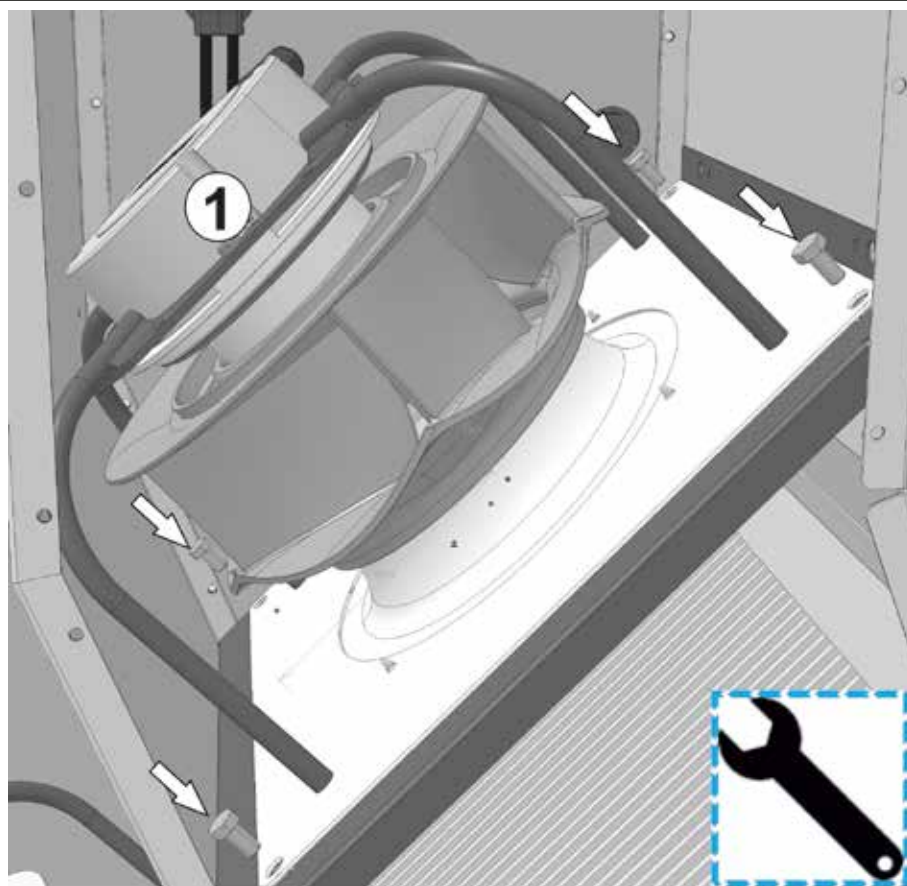

8.

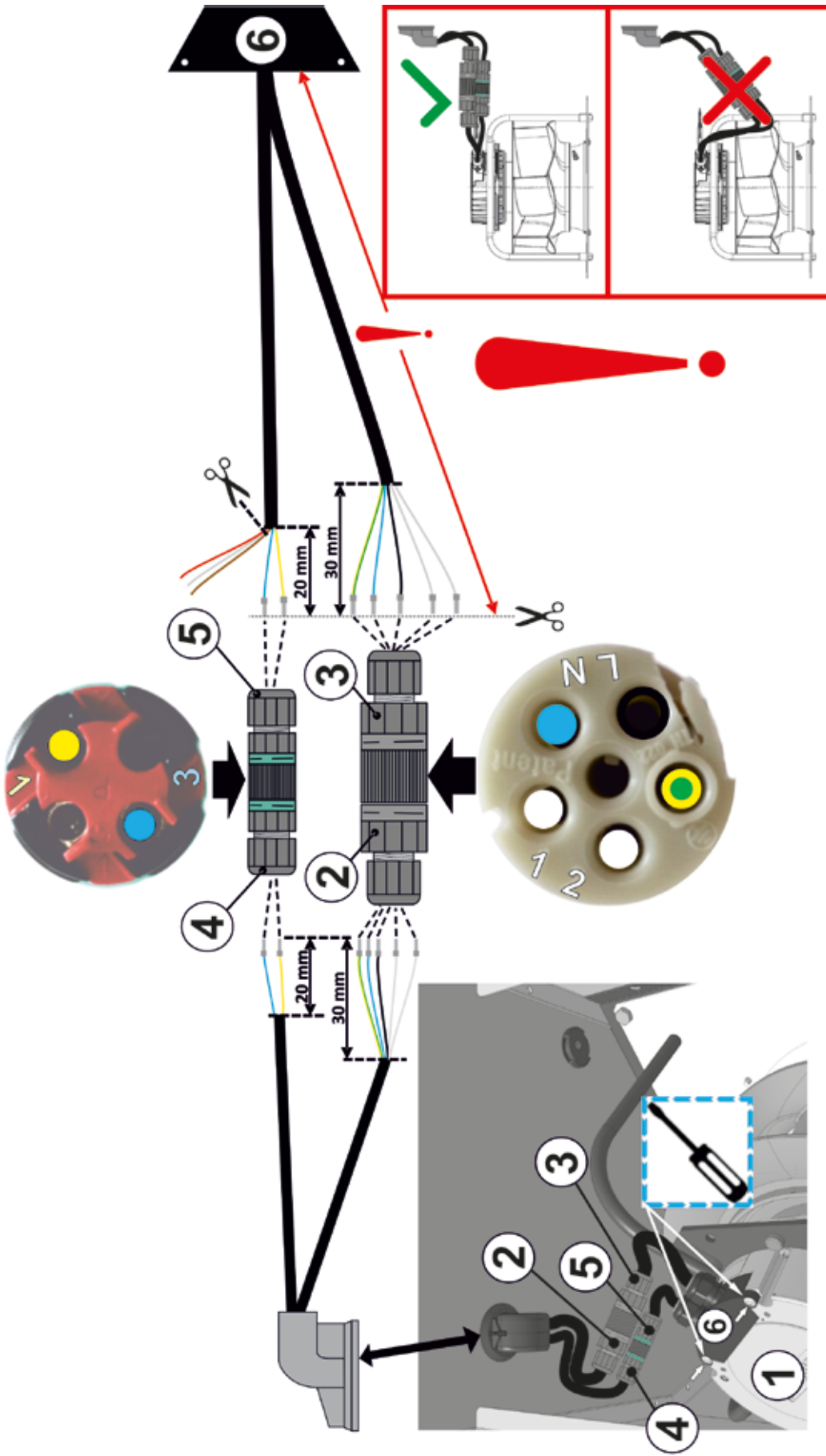

9.

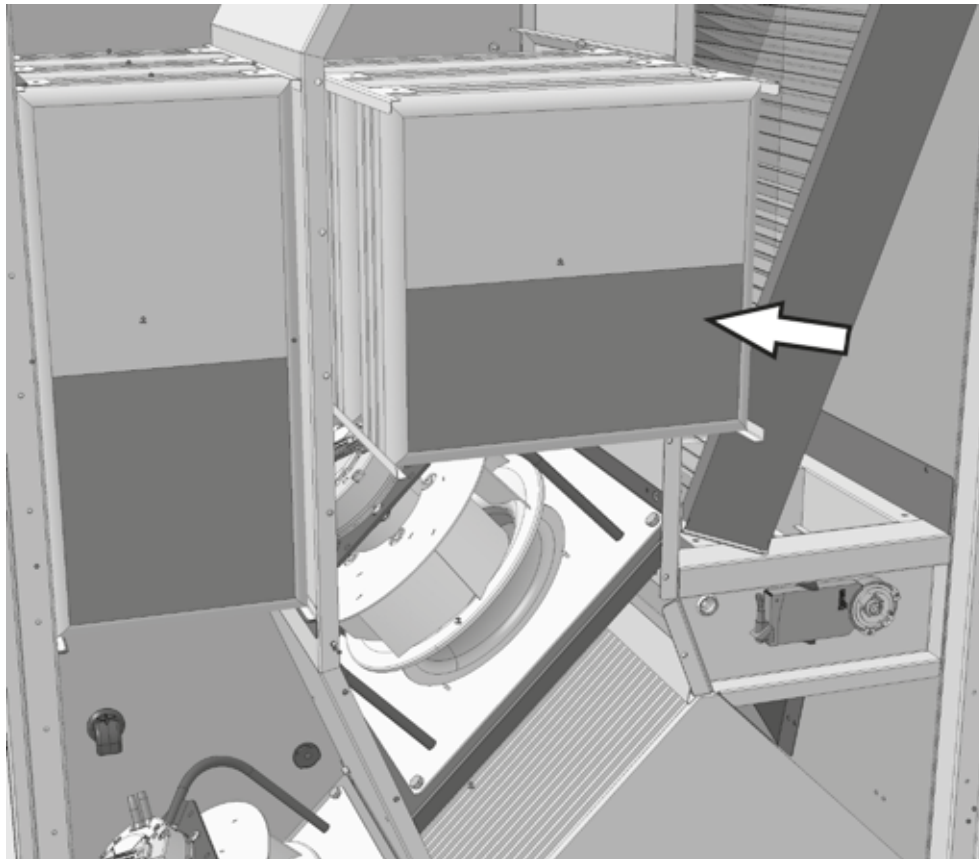

10.

1

Volumenstrombestimmung
 q_v Volumenstrom in m^3/h
 Δp_w Düsendifferenzdruck in Pa
 $q_v = k \cdot \sqrt{\Delta p_w}$ (bei Normbedingungen)
 K3G250-PR04-V6 **k=76**

Volumenstrombestimmung
 q_v Volumenstrom in m^3/h
 Δp_w Düsendifferenzdruck in Pa
 $q_v = k \cdot \sqrt{\Delta p_w}$ (bei Normbedingungen)
 K3G250-PR04-V6 k=76





WOLF GmbH / Postfach 1380 / D-84048 Mainburg
Tel. +49.0.87 51 74- 0 / Fax +49.0.87 51 74- 16 00 / www.WOLF.eu